

## SPECIFICATIONS

Design	28000 Lit./min(50Hz)
Displacement	35000 Lit./min(60Hz)
Speed	920 r.p.m. (50Hz)
	1150 r.p.m. (60Hz)
Normal usage vacuum pressure	Under Torr
Attainable vacuum pressure	Max 50Torr
Suction port diameter	KS 150A (2)
Motor	Horizontal Motor Standard 3-Phase 220/380V 60Hz 75kW 6P
Water Capacity	15°C 기준 150L/MIN
Weight	870 Kg
Painting	Color- VL951 (Company's standard)
Allowable ambient temp.	-10~40 °C

-1 Excluding motor and some other parts.

## Curve referred to dry air at 20°C (68°F) 배기량 SUCTION CAPACITY

냉각수 온도 15°C 기준

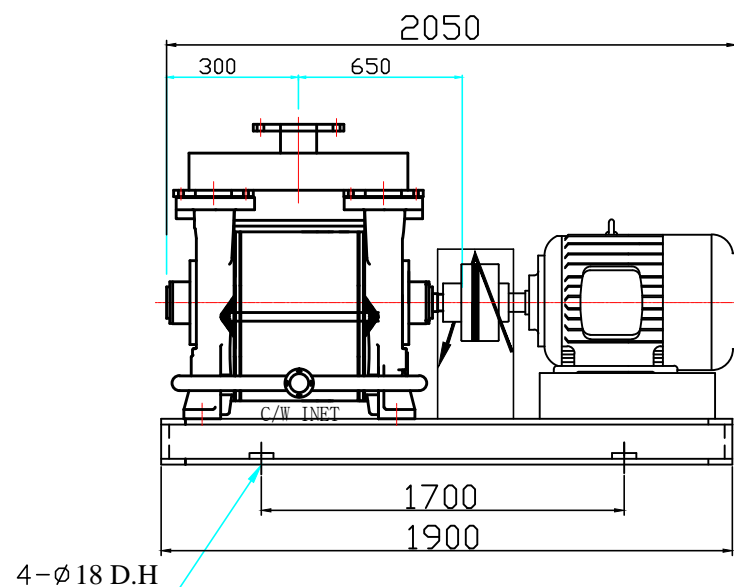
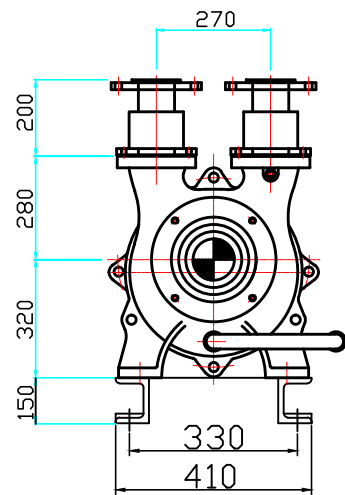
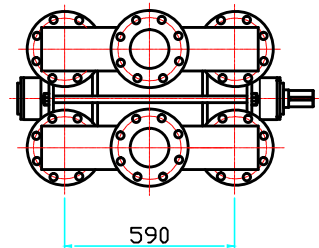
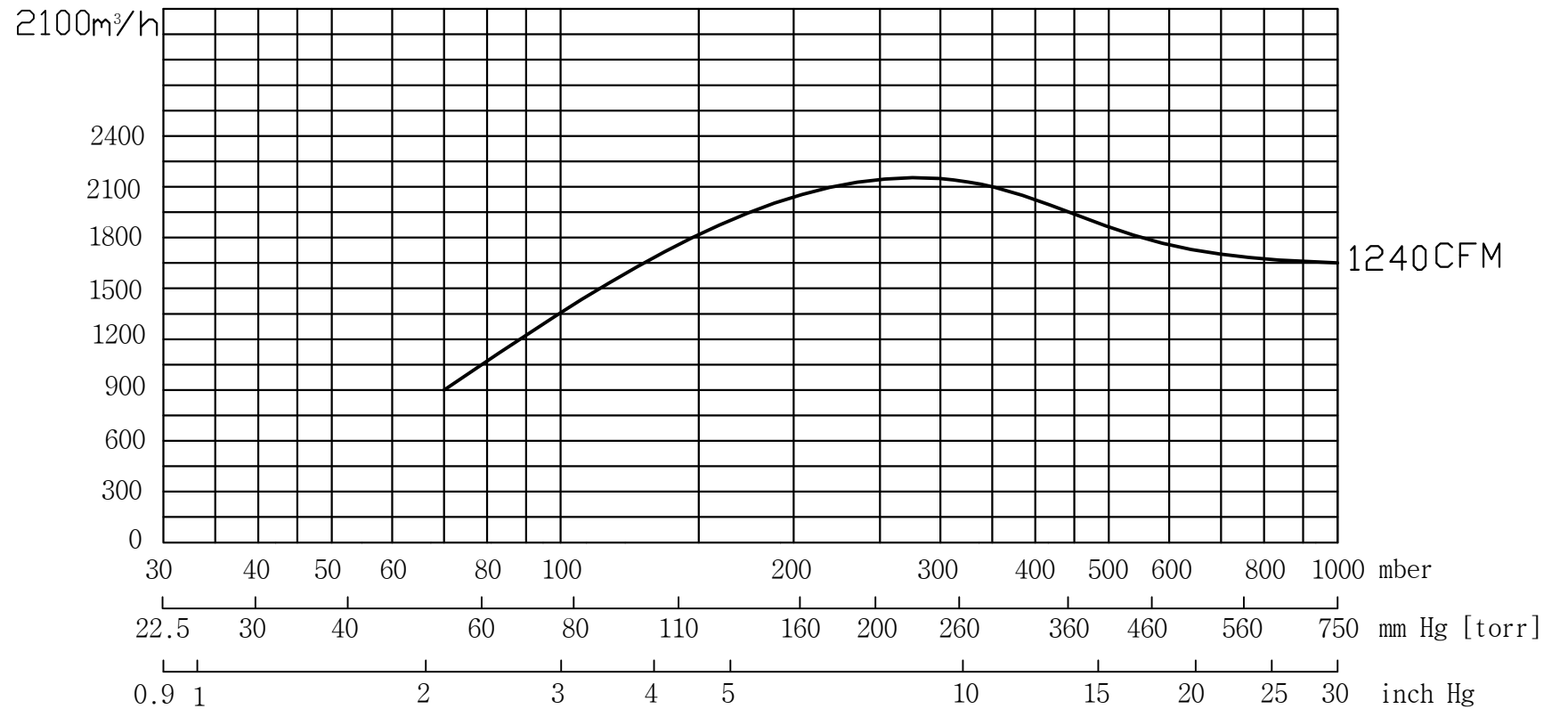

### ACCESSORIES(Option)

- Vacuum Manual Valve
- Vacuum gauge
- Vacuum Check Valve
- Separator Tank

### CONSUMABLE LIST

(Vacuum.ENG GENUINE PARTS)

Designation	Specification	Quantity/set
Grand packing		2
Bearing	5314,NU314 ZZ (Special Heat - resisting grease)	2
Pulley	(M)φ300 (P)φ400	1
Shaft key	φ60 80 X 9	1

DWG DATE	SCALE		TITLE
2016.02.18	N/S		WATER RING V/P
DWGBY	DESNBY	CHDBY	APPROVE
			CLIENT
			LOCATION
			DWG NO
			JLRP1-350

- 품질 개선을 위해서 예고없이 변경 될수 있음.
- Not binding dimension that can change according to motor make